

ALL DESIGN, OPERATIVE AND PROCESS DATA PERTAINING TO THE ARTICLE SHOWN ON THIS SHEET IS THE PROPERTY OF POLYPHASER CORPORATION. THE INFORMATION IS TO BE USED ONLY FOR THE PART AND QUANTITY OR APPROVED BY OTHERS WITHOUT THE EXPRESS WRITTEN CONSENT OF POLYPHASER CORPORATION.

REVISIONS				
REV LTR	DATE	ENG	MKTG	Q.A.
E	08/28/06	SH	LC	SD
				LJ

MAXIMUM CHARACTERISTICS DATA (X-L)	
TURN-ON(@10mA):	±12Vdc TYPICAL
UL 497B STRIKE VOLTAGE BREAKDOWN (100 Vdc/SEC RISE):	±10.0 TO ±12.4 Vdc
RESISTANCE:	1Ω ±20%
DATA RATE:	UP TO 25Mbps
MAX HOLDING CURRENT:	400mA @ +20°C
	620mA @ -40°C
	290mA @ +50°C
	235mA @ +65°C

GENERAL CHARACTERISTICS	
SURGE:	BELLCORE 1089 10/1000μs 100A
TEMPERATURE:	-40°C TO +65°C STORAGE/OPERATING
WIRE RANGE:	16 TO 28 AWG.
CORD DIAMETER:	0.114 TO 0.225 INCH W/ SMALL GROMMET
	0.250 TO 0.350 INCH W/ LARGE GROMMET
APPLICATION:	PANEL MOUNT.
	WEATHERIZED AFTER PROPER INSTALLATION OF GROMMETS AND TORQUING OF LID.
ENVIRONMENTAL:	MEETS BELLCORE #TA-NWT-000487 PROCEDURE 4.11, WIND DRIVEN RAIN (70MPH) RAIN INTRUSION TEST.

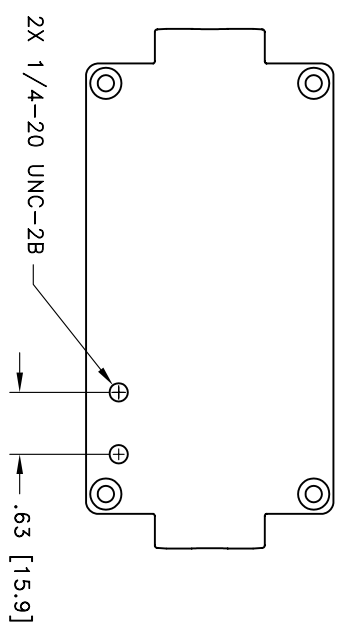
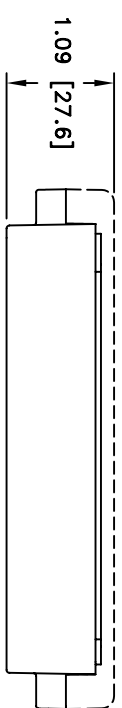
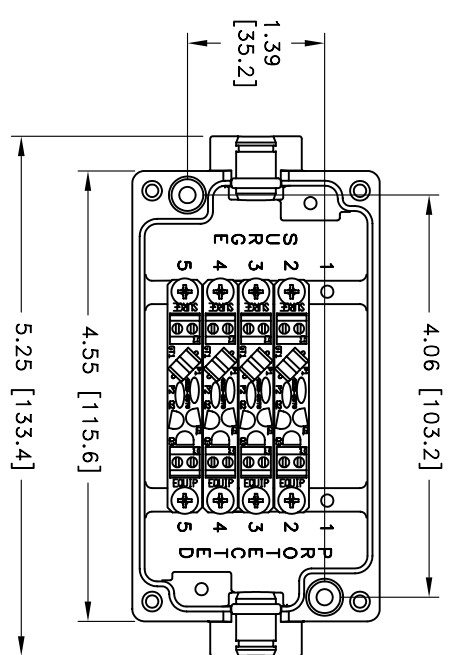
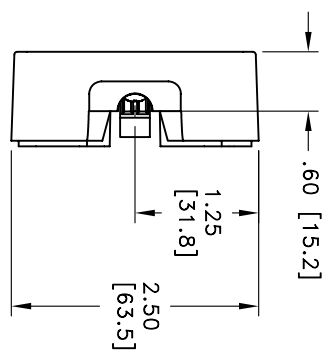

CUSTOMER APPROVAL: _____ DATE: _____
 ALL DIMENSIONS SHOWN ABOVE ARE FOR REFERENCE ONLY.

DESIGNER	S. HALL	DATE	05/12/03	
MECH ENGINEER	R. DUNNING	DATE	05/14/03	
ELEC ENGINEER	L. CHANG	DATE	05/14/03	
MARKETING	S. DOTTER	DATE	05/14/03	
QUALITY DEPT	L. JACQUES	DATE	05/14/03	
P.O. BOX 9000, LINDEN, NJ 08036 TEL: 775-782-2511 FAX: 775-782-4476 DWG NO/PART NO/DESCRIPTION				CUSTOMER PRINT IX-4L
CAGE CODE	FILE NAME	SCALE	SHEET	
61114	-C1	NOTED	1 OF 1	

- NOTES:
- TORQUE 4X M4-20mm LID SCREWS TO 11bf-in MINIMUM.
 - ENSURE THAT ALL GROMMETS ARE PROPERLY SEATED FOR ENVIRONMENTAL SPECIFICATIONS.